

**INDUSTRIAL
RADIATION
PROCESS CONTROL**

Modeling and Simulation

PK-*Trainer*

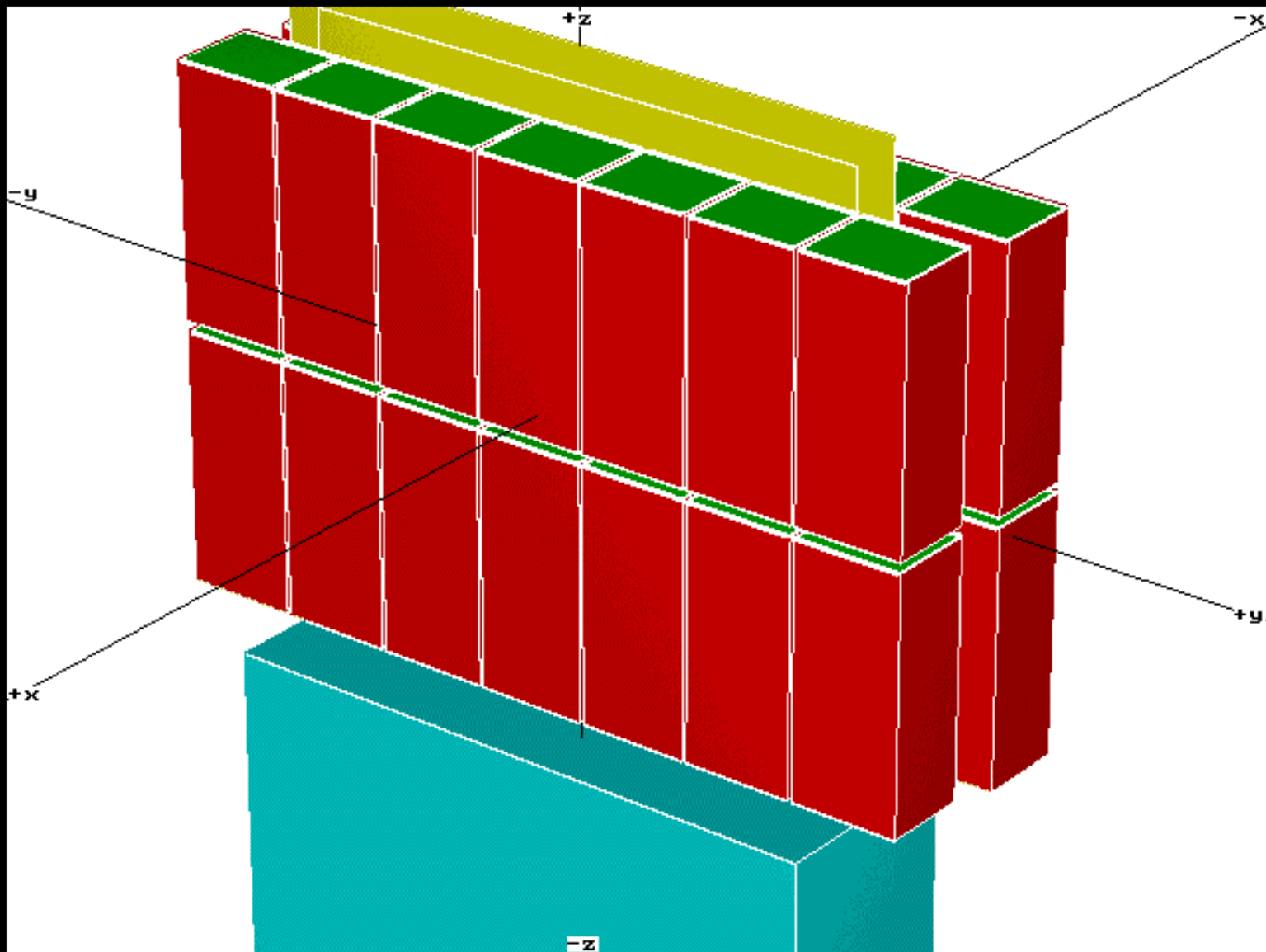

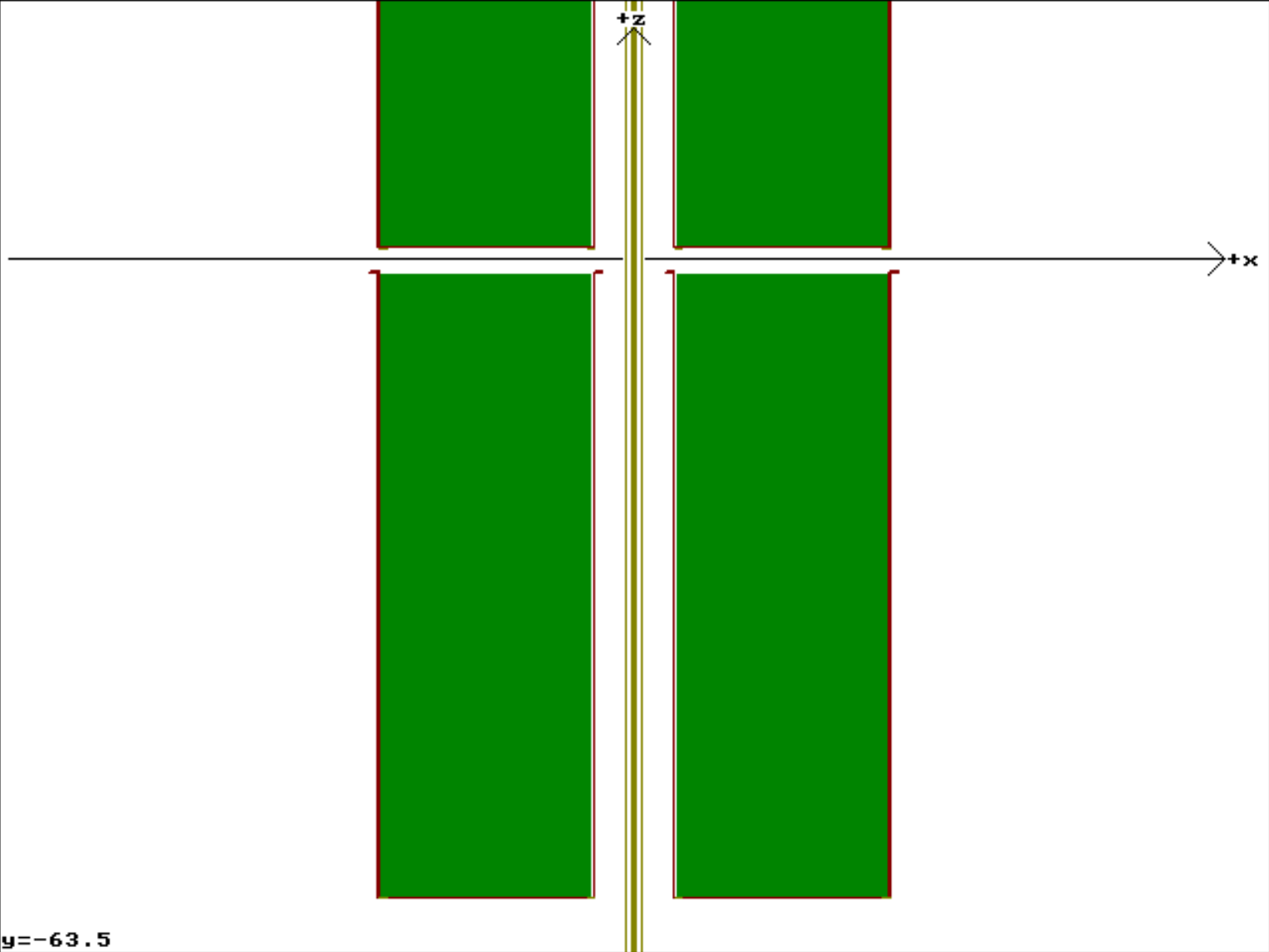

NOVICE.QAD: cobalt 399 points, 0.59 g/cc, 2.72E+02 rad/s, 1.00 1.00 ratio

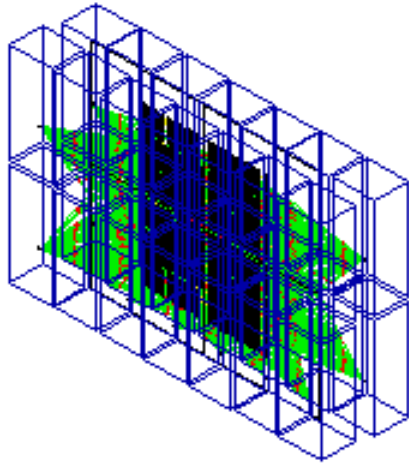

xyz



zx



xy

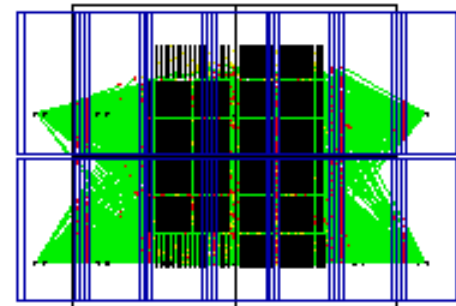

yz

NOVICE.QAD: cobalt 399 points, 0.77 g/cc, 6.49E-01 rad/s, 1.00 1.00 ratio

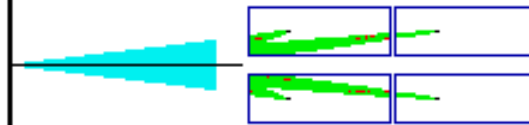
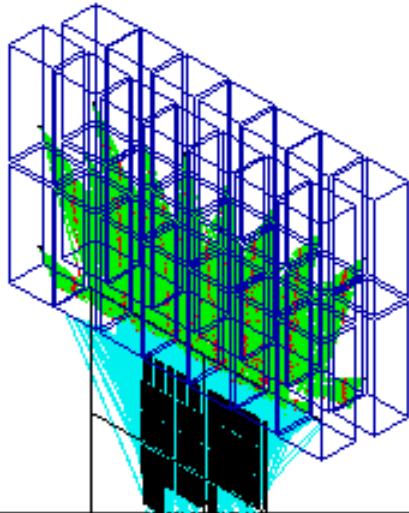

ZX



xy

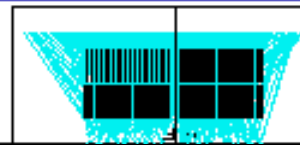
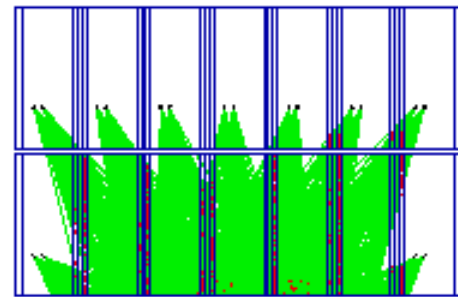

NOVICE.QAD: cobalt 399 points, 0.40 g/cc, 4.08E+02 rad/s, 1.00 1.00 ratio

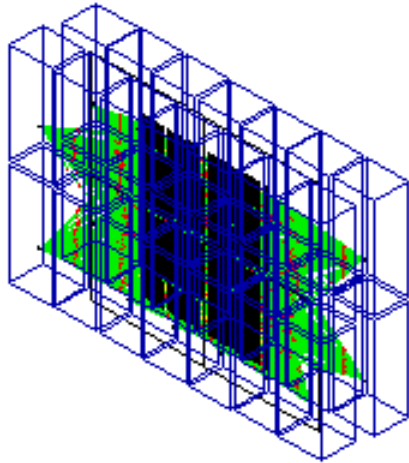

xyz

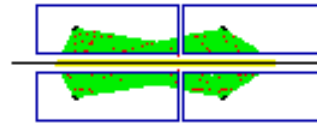

zx

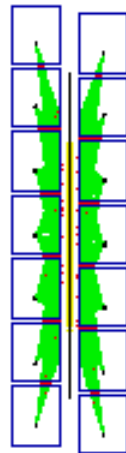

xy

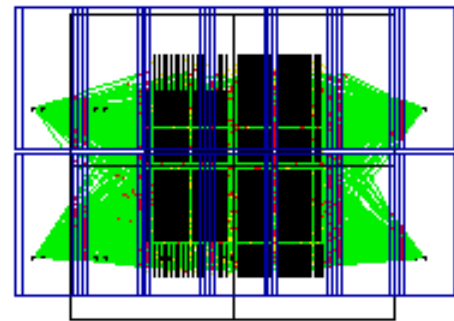

yz

NOVICE.QAD: cobalt 399 points, 0.40 g/cc, 4.10E+02 rad/s, 1.00 1.00 ratio

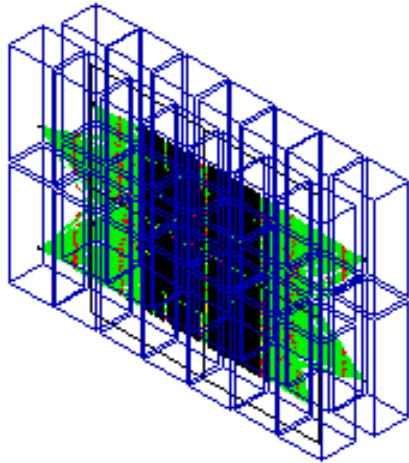

xyz



zx



xy

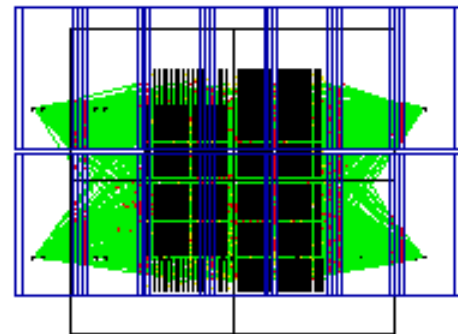

yz

NOVICE.QAD:

cobalt 399 points, 0.40 g/cc, 4.10E+02 rad/s, 1.00 1.00 ratio

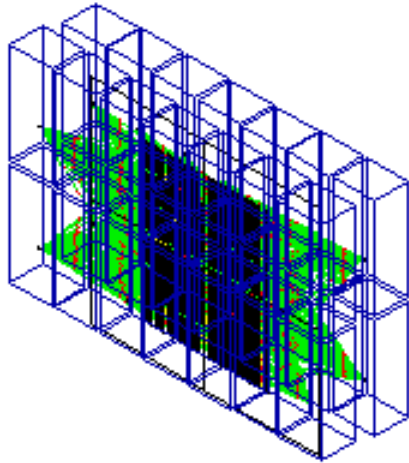

xyz



zx



xy

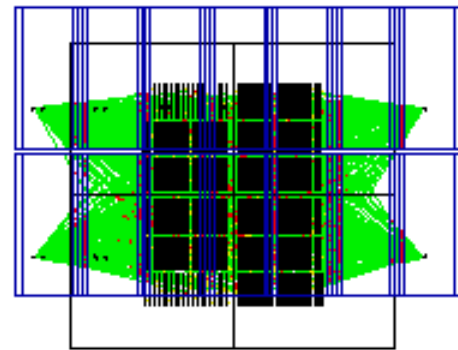

yz

NOVICE.QAD: cobalt 399 points, 0.40 g/cc, 4.07E+02 rad/s, 1.00 1.00 ratio

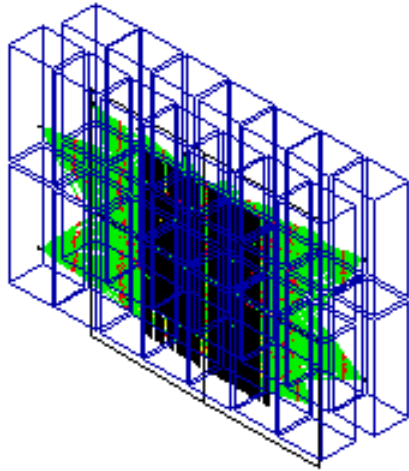

xyz

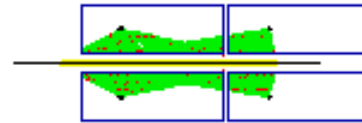

zx



xy

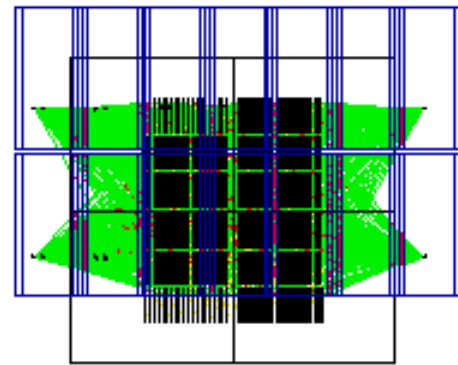

yz

NOVICE.QAD: cobalt 399 points, 0.40 g/cc, 4.02E+02 rad/s, 1.00 1.00 ratio

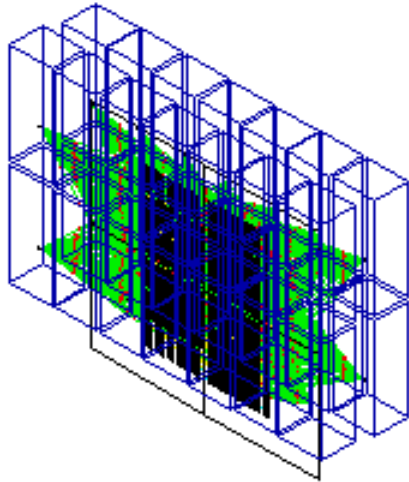

xyz



zx



xy

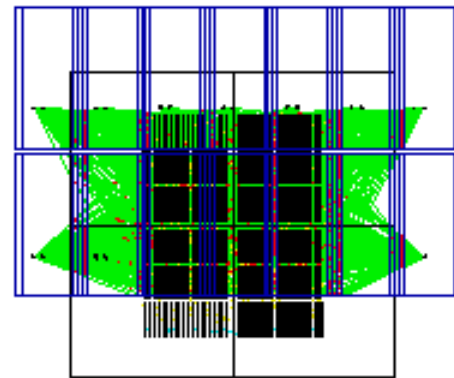

yz

NOVICE.QAD: cobalt 399 points, 0.40 g/cc, 3.93E+02 rad/s, 1.00 1.00 ratio

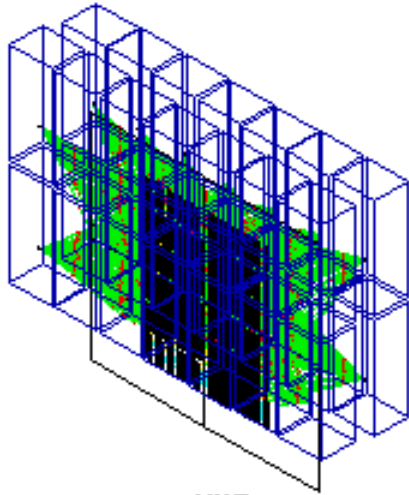

xyz

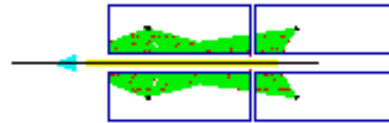

zx

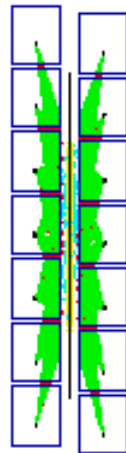

xy

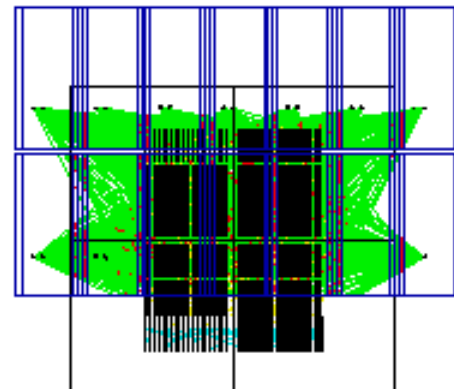

yz

NOVICE.QAD: cobalt 399 points, 0.40 g/cc, 3.79E+02 rad/s, 1.00 1.00 ratio

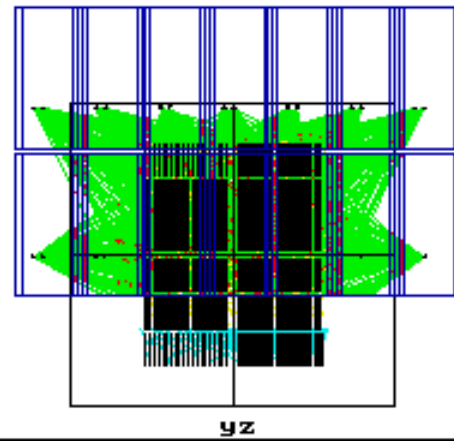
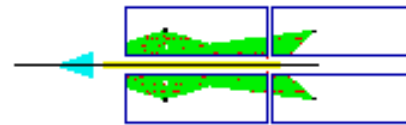
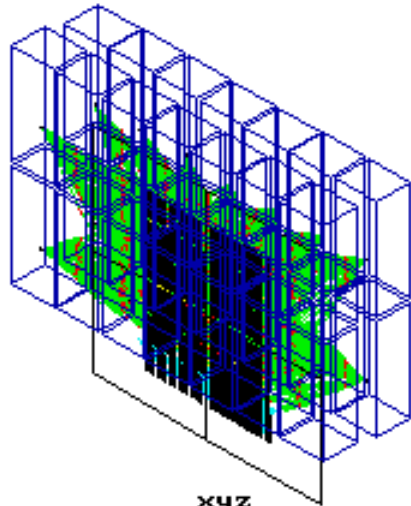

NOVICE.QAD:

cobalt 399 points, 0.41 g/cc, 3.65E+02 rad/s, 1.00 1.00 ratio

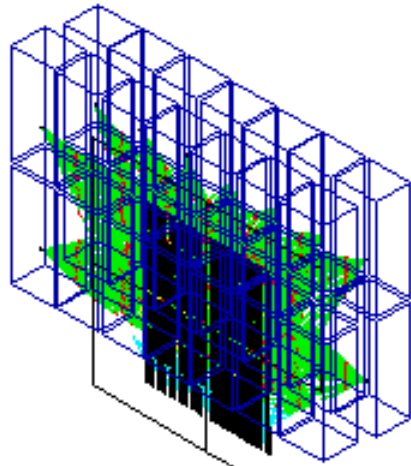

xyz

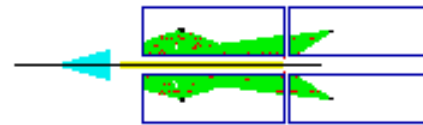

zx

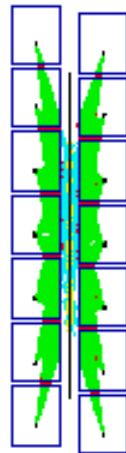

xy

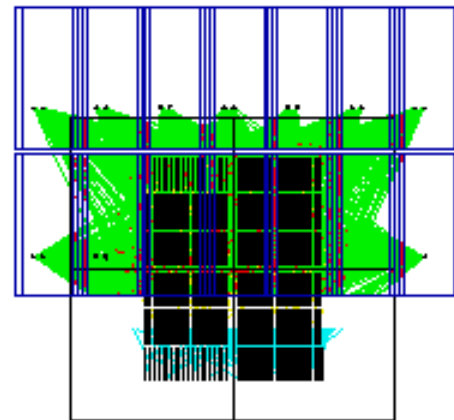

yz

NOVICE.QAD: cobalt 399 points, 0.43 g/cc, 3.40E+02 rad/s, 1.00 1.00 ratio

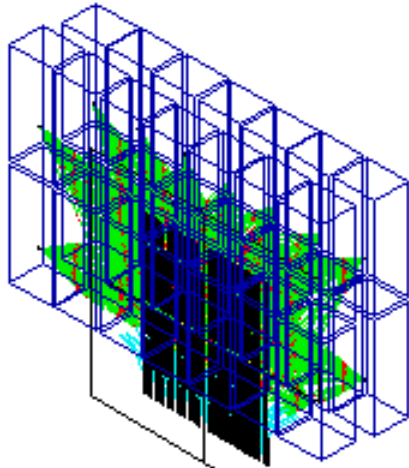

xyz

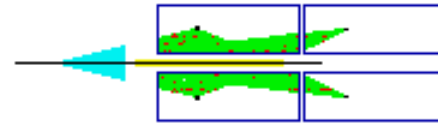

zx



xy

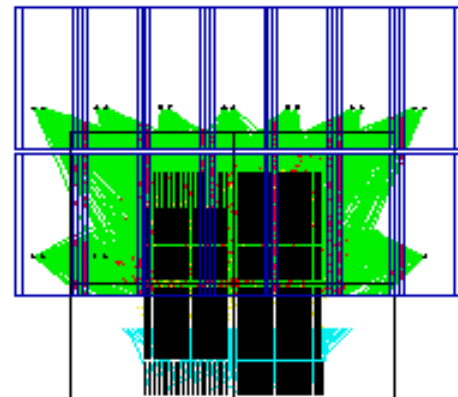

yz

NOVICE.QAD: cobalt 399 points, 0.44 g/cc, 3.07E+02 rad/s, 1.00 1.00 ratio

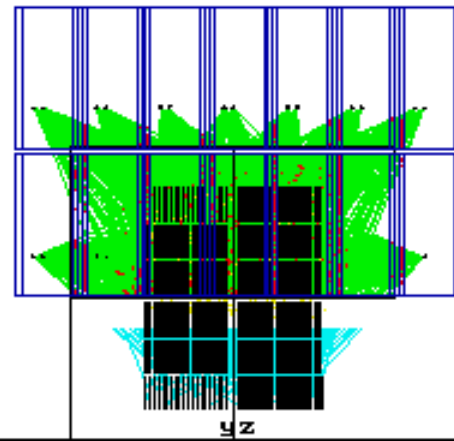
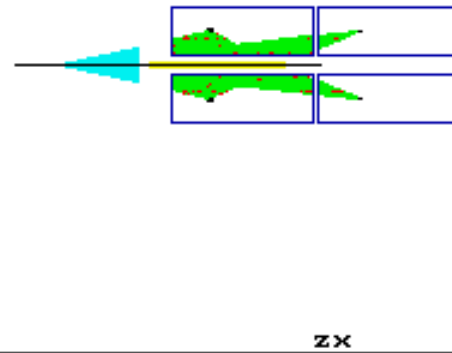
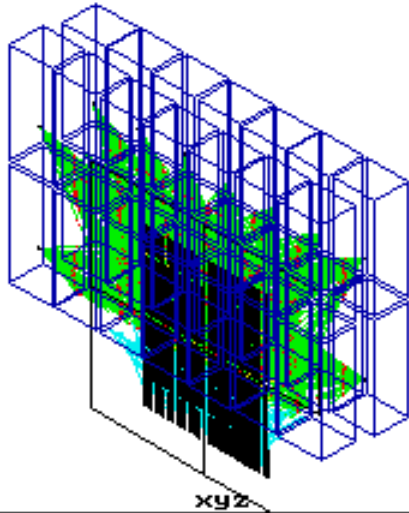

NOVICE.QAD: cobalt 399 points, 0.46 g/cc, 2.64E+02 rad/s, 1.00 1.00 ratio

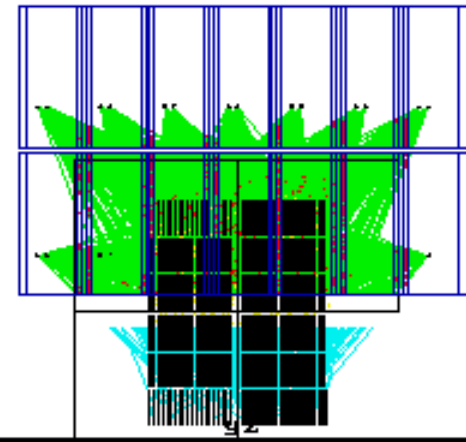
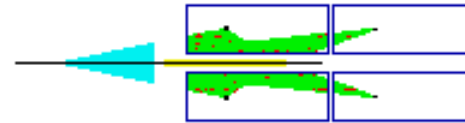
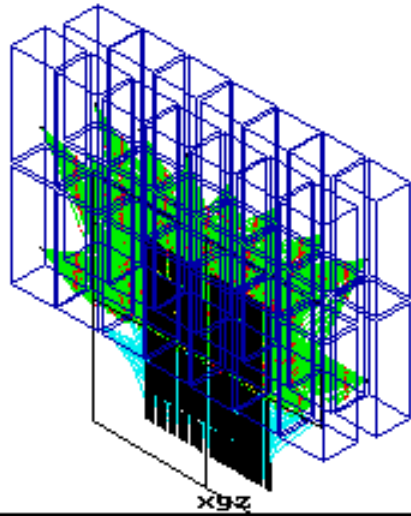

NOVICE.QAD: cobalt 399 points, 0.49 g/cc, 2.07E+02 rad/s, 1.00 1.00 ratio

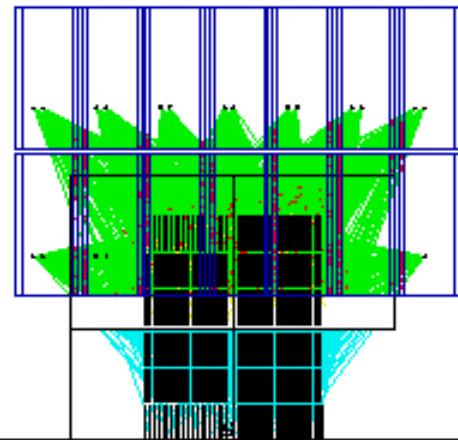
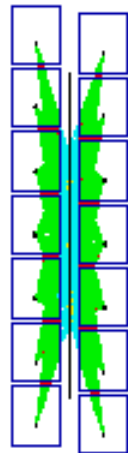
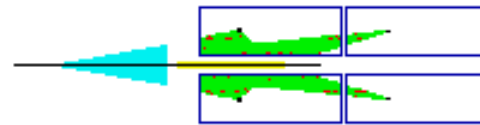
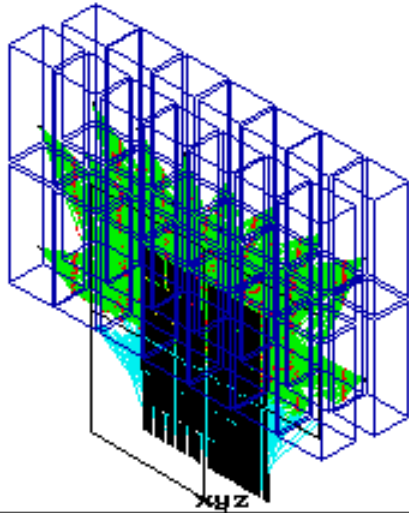

NOVICE.QAD: cobalt 399 points, 0.51 g/cc, 1.53E+02 rad/s, 1.00 1.00 ratio

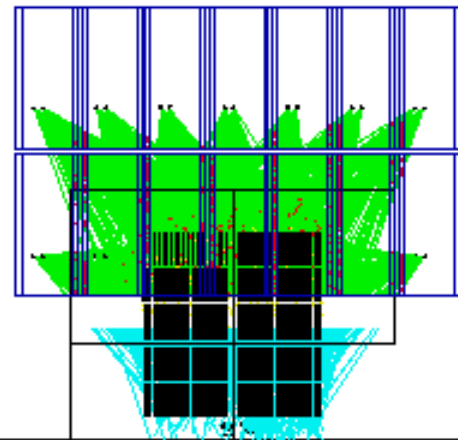
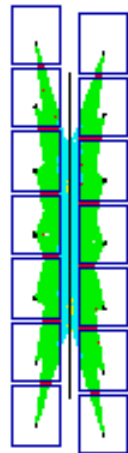
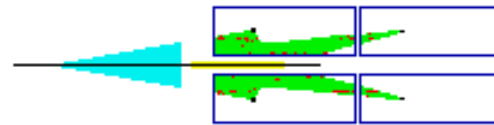
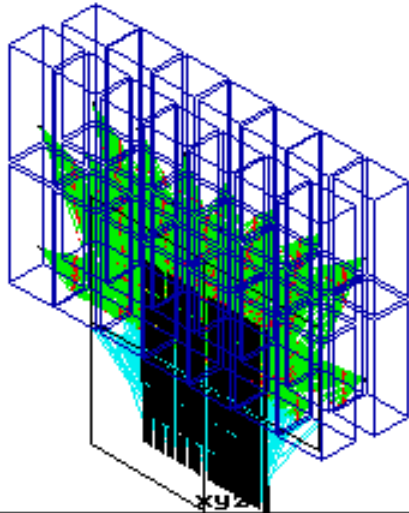

NOVICE.QAD: cobalt 399 points, 0.53 g/cc, 1.07E+02 rad/s, 1.00 1.00 ratio

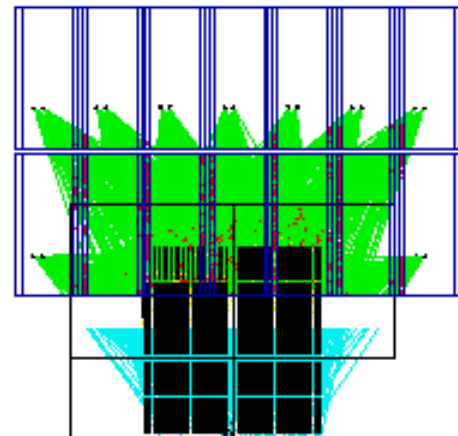
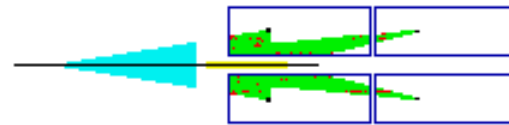
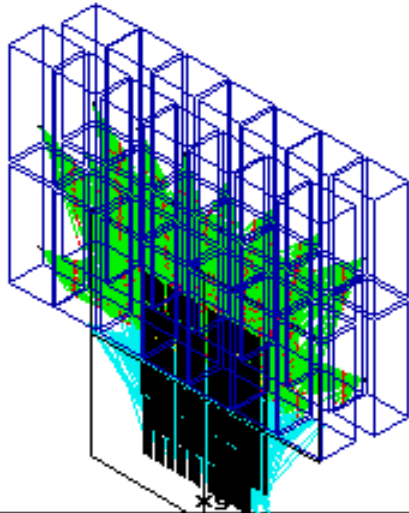

NOVICE.QAD: cobalt 399 points, 0.55 g/cc, 6.98E+01 rad/s, 1.00 1.00 ratio

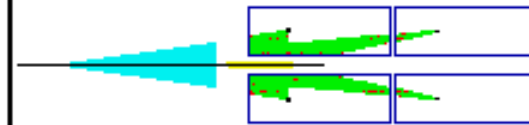
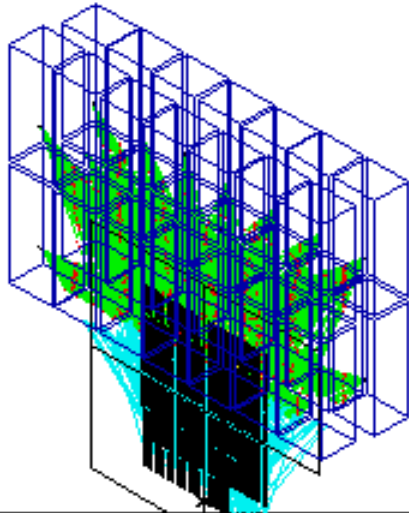

zx



xy

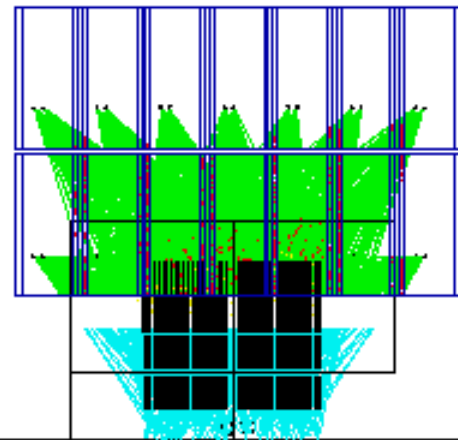

NOVICE.QAD: cobalt 399 points, 0.58 g/cc, 4.43E+01 rad/s, 1.00 1.00 ratio

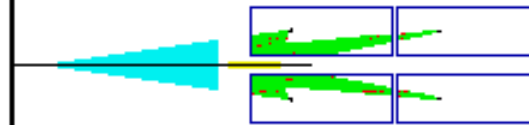
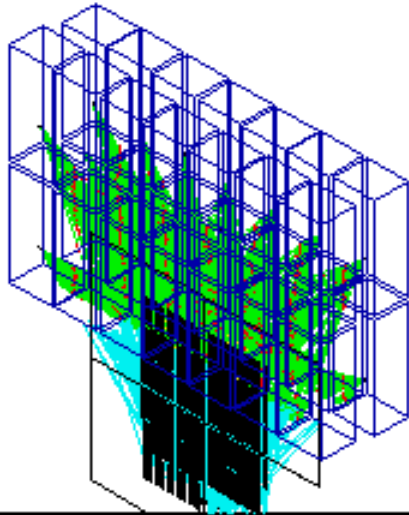

ZX



XY

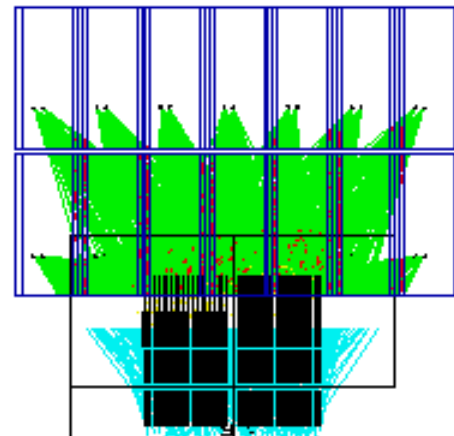

NOVICE.QAD: cobalt 399 points, 0.60 g/cc, 2.47E+01 rad/s, 1.00 1.00 ratio

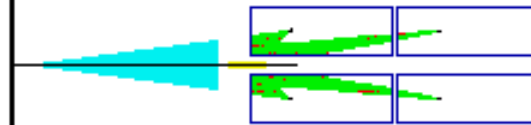
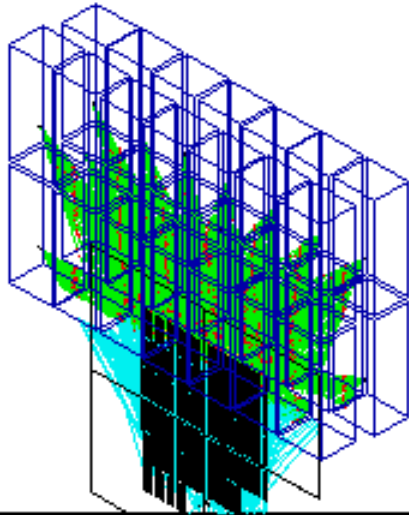

zx



xy

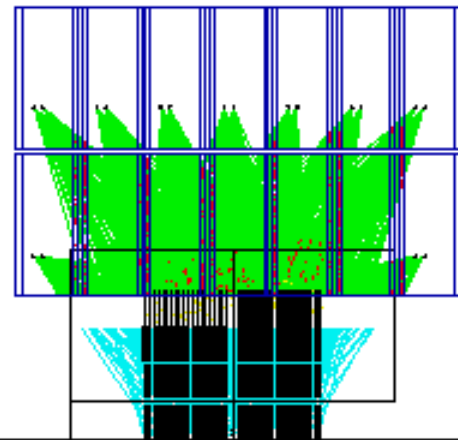

NOVICE.QAD: cobalt 399 points, 0.62 g/cc, 1.17E+01 rad/s, 1.00 1.00 ratio

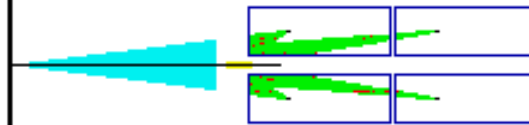
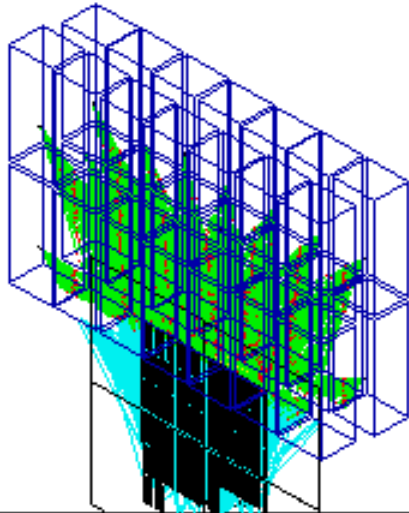

zx

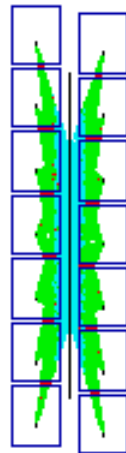

xy

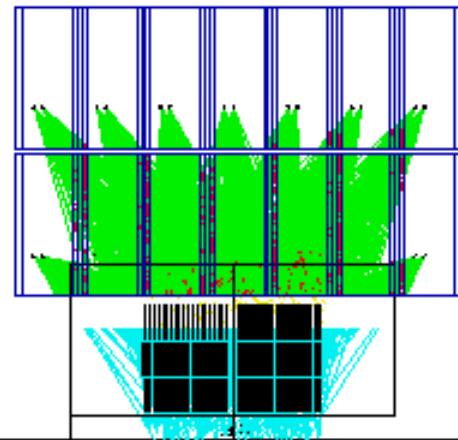

NOVICE.QAD: cobalt 399 points, 0.64 g/cc, 5.41E+00 rad/s, 1.00 1.00 ratio

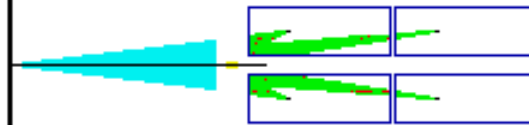
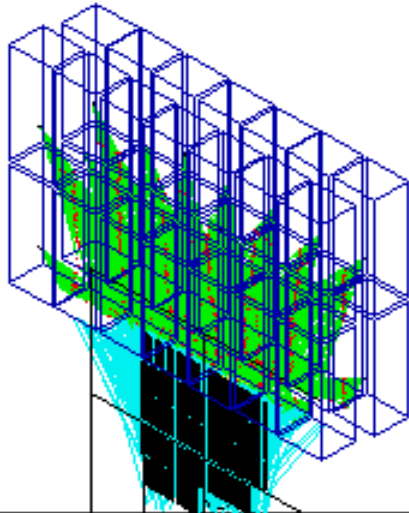

ZX



xy

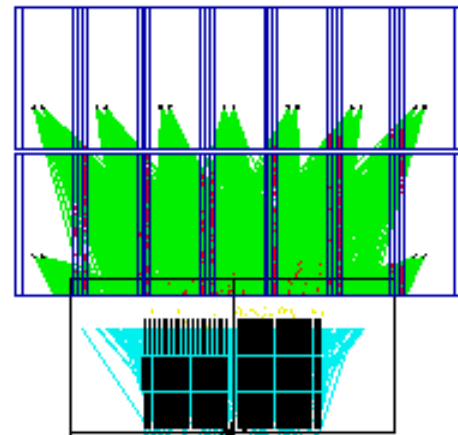

NOVICE.QAD: cobalt 399 points, 0.66 g/cc, 2.22E+00 rad/s, 1.00 1.00 ratio

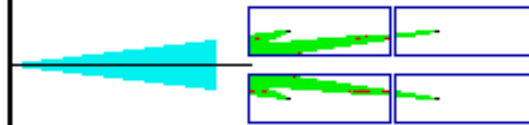
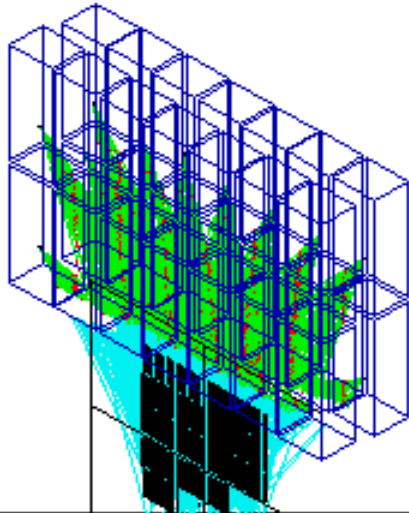

zx



xy

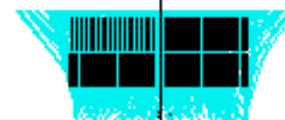
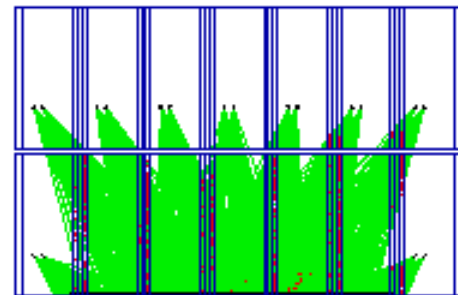

NOVICE.QAD: cobalt 399 points, 0.68 g/cc, 1.14E+00 rad/s, 1.00 1.00 ratio

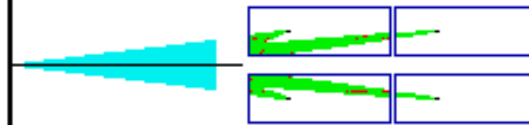
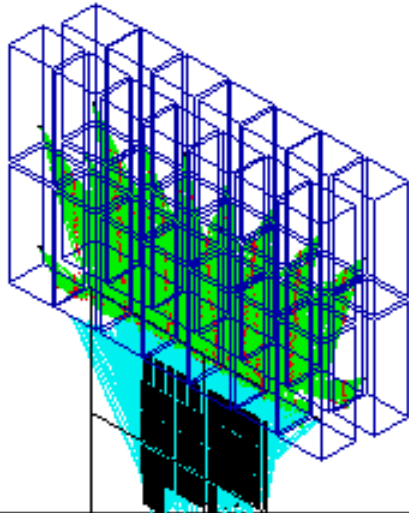

ZX



xy

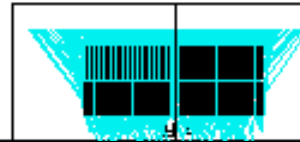
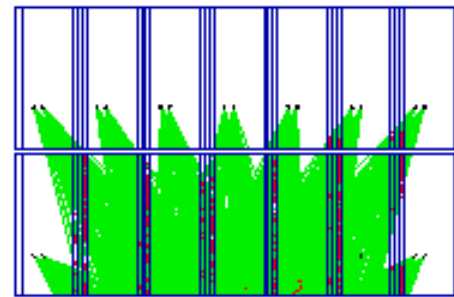

NOVICE.QAD: cobalt 399 points, 0.68 g/cc, 8.06E-01 rad/s, 1.00 1.00 ratio

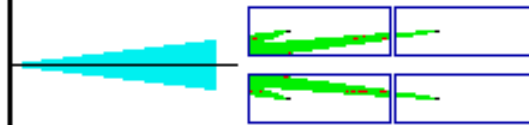
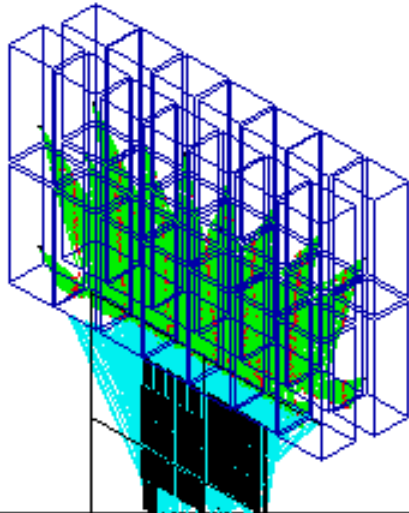

zx



xy

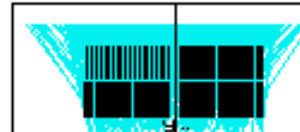
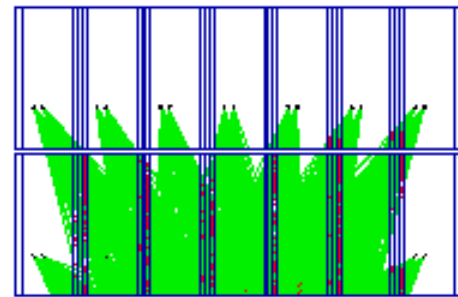

NOVICE.QAD: cobalt 399 points, 0.70 g/cc, 2.87E-01 rad/s, 1.00 1.00 ratio

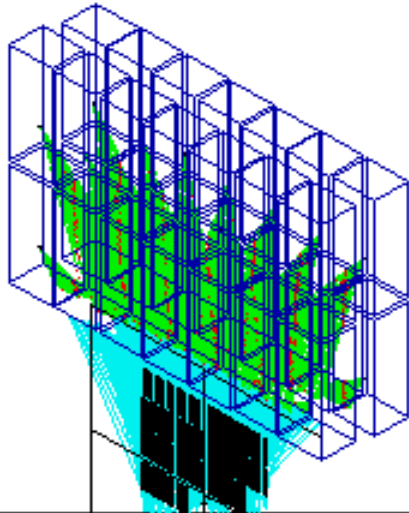

ZX

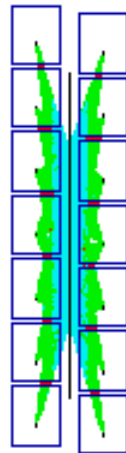

XY

